



BOTANIKA

NATURE RESIDENCES

TOWER 1

Featured Unit:

Garden Unit B | 3 Bedroom Flat

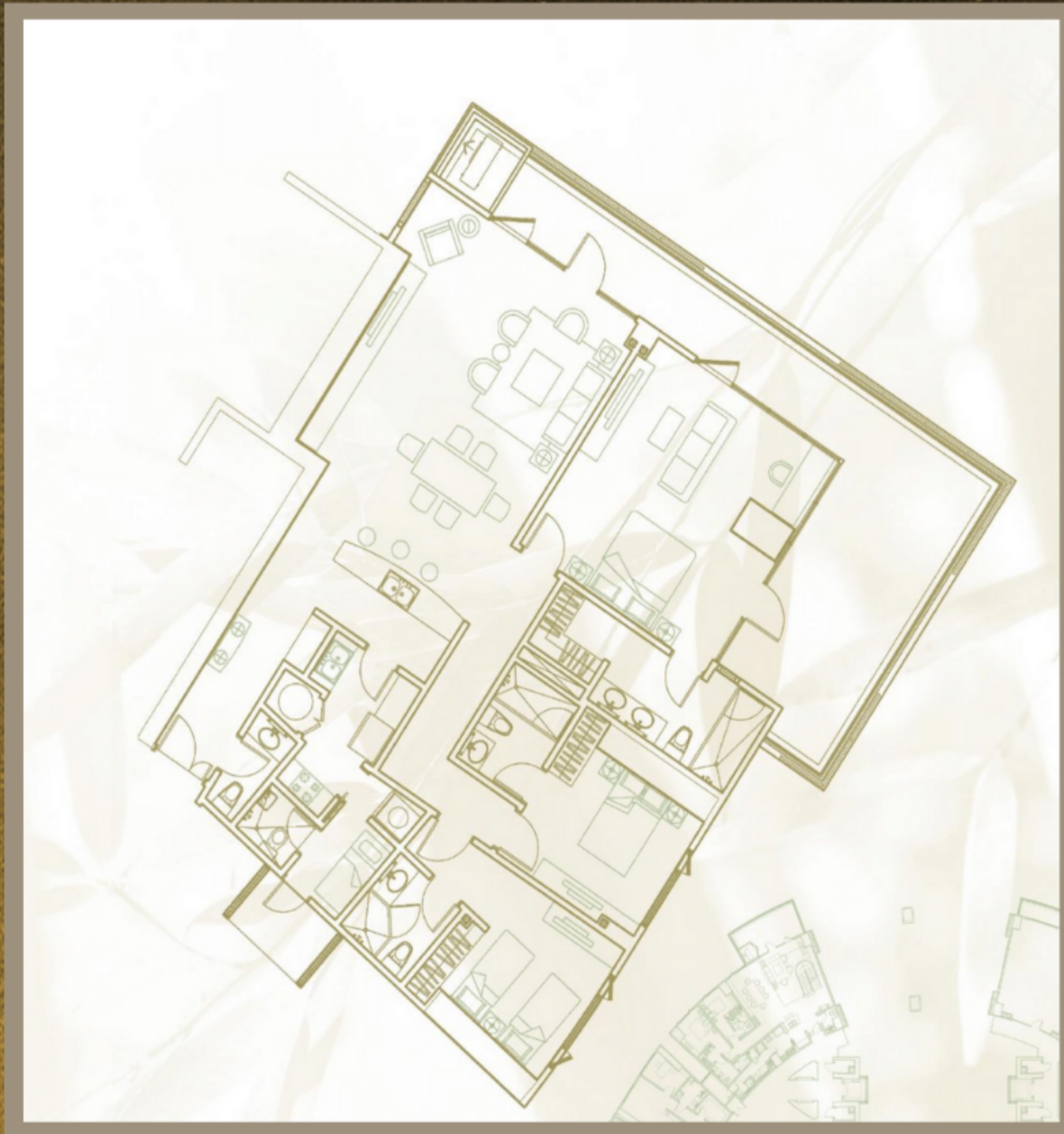

Total Area: ± 230 sqm

Livable Area: ± 184 sqm

- Generous living and dining area
- All bedrooms with ensuite T&B
- Powder room
- Maid's/utility area with T&B
- View of greeneries
- 3 appurtenant parking slots

A Fine Residential Masterpiece by

FILIGREE



BOTANIKA
NATURE RESIDENCES

TOWER 1

Garden Unit B

TOWER 1 | 3BR GARDEN FLAT | ± 230 sqm
3 Parking Slots

PARTICULARS	MAXIMUM DISCOUNT	SIZEABLE DISCOUNT, STRETCHED PERIOD			PROMO TERM
	Cash 30 days	Deferred 30% / 70% (over 24 mos)	Deferred 20% / 80% (over 24 mos)	Deferred 10% / 90% (over 24 mos)	10% / 10% (over 24 mos) / 80% thru bankfin or lumpsum
STANDARD DISCOUNT	15% (10,414,500)	5% (P3,471,500)	4% (P2,777,200)	3% (P2,082,900)	-
TOTAL CONTRACT PRICE	P75,623,100	P83,694,300	P84,501,400	p85,308,600	P87,729,900
RESERVATION FEE	P200,000	P200,000	P200,000	P200,000	P200,000
DOWNPAYMENT	P75,423,100 30 days from RF	P24,908,290 30% net of RF	P16,700,280 20% net of RF	P8,330,860 10% net of RF	P8,572,990 10% net of RF
BALANCE	-	P2,441,083.75/mo 70% over 24 mos	P2,816,713.33 80% over 24 mos	P3,199,072.50 90% over 24 mos	P365,541.25 10% over 24 mos
LUMPSUM		-	-		P70,183,920 80% lumpsum

- Reservation Fee is ₱200,000.
- Computation and schemes as of January 2024
- This document does not constitute nor form part of any contract and is for information purposes only.
- FAI reserves the right to incorporate changes and improvements without the need for notice and republication.
- Client is advised to request for detailed payment schedule for his preferred scheme from his trusted account specialist/broker.

A Fine Residential Masterpiece by

