

TWO BOTANIKA

NATURE RESIDENCES

Unit 3D

FLOOR PLAN

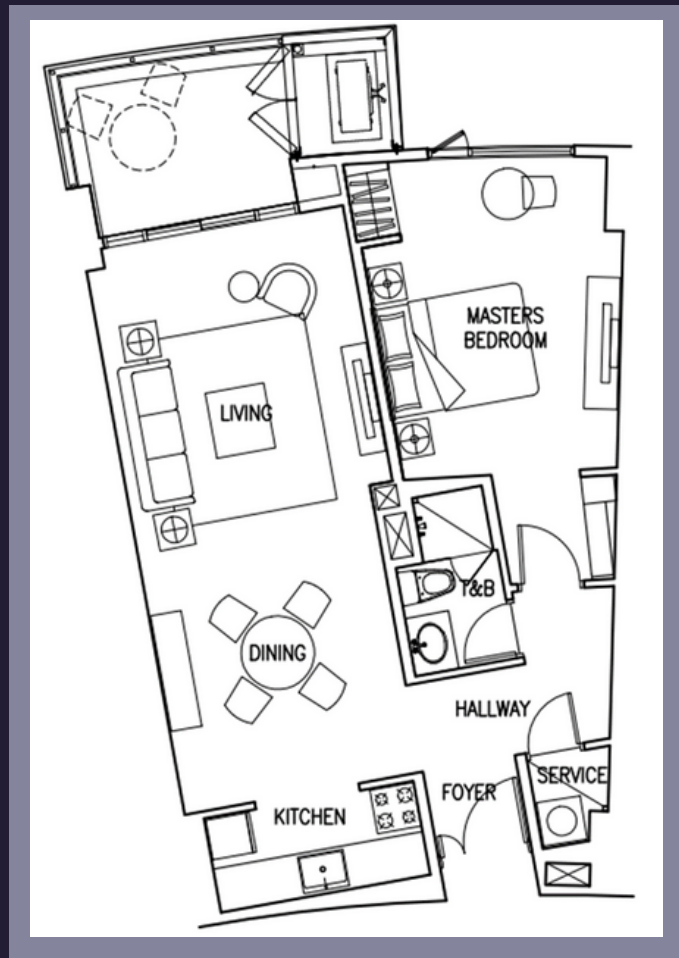

Total Area: ± 72 sqm
Livable Area: ± 65 sqm

- Generous living and dining area
- Kitchen with modular cabinet system
- Spacious lanai
- Utility area
- 1 appurtenant parking slot

A Fine Residential Masterpiece by

FILIGREE

Unit 3D

TOWER 2 | 1BR SUITE | ± 72 sqm
1 Parking Slot

PARTICULARS	MAXIMUM DISCOUNT	SIZEABLE DISCOUNT, STRETCHED PERIOD		PROMO TERM
	Modified Cash 95-5	Split Deferred 30 over 6 mos- 70 over 54 mos	Split Deferred 10 over 6 mos- 90 over 54 mos	No DP - 25 over 48- 75 Lumpsum
STANDARD DISCOUNT	10% (P2,057,000)	3% (P617,100)	1% (P205,700)	-
TOTAL CONTRACT PRICE	P23,903,900	P25,577,700	P26,056,000	P26,295,100
RESERVATION FEE	P200,000	P200,000	P200,000	P200,000
DOWNPAYMENT	P22,508,705 95% net of RF	P1,245,551/mo 30% net of RF over 6mos	P400,933/mo 10% net of RF over 6mos	-
BALANCE	-	P426,295/mo 70% over 42 mos	P558,342/mo 90% over 42 mos	P132,786/mo 25% over 48 mos
LUMPSUM	P1,195,195 5% lumpsum	-	-	P19,721,325 70% lumpsum

- Reservation Fee is ₱200,000.
- Computation and schemes as of January 2024
- This document does not constitute nor form part of any contract and is for information purposes only.
- FAI reserves the right to incorporate changes and improvements without the need for notice and republication.
- Client is advised to request for detailed payment schedule for his preferred scheme from his trusted account specialist/broker.