



BOTANIKA

NATURE RESIDENCES

TOWER 1

Featured Unit:

Unit 8G | 3 Bedroom Deluxe

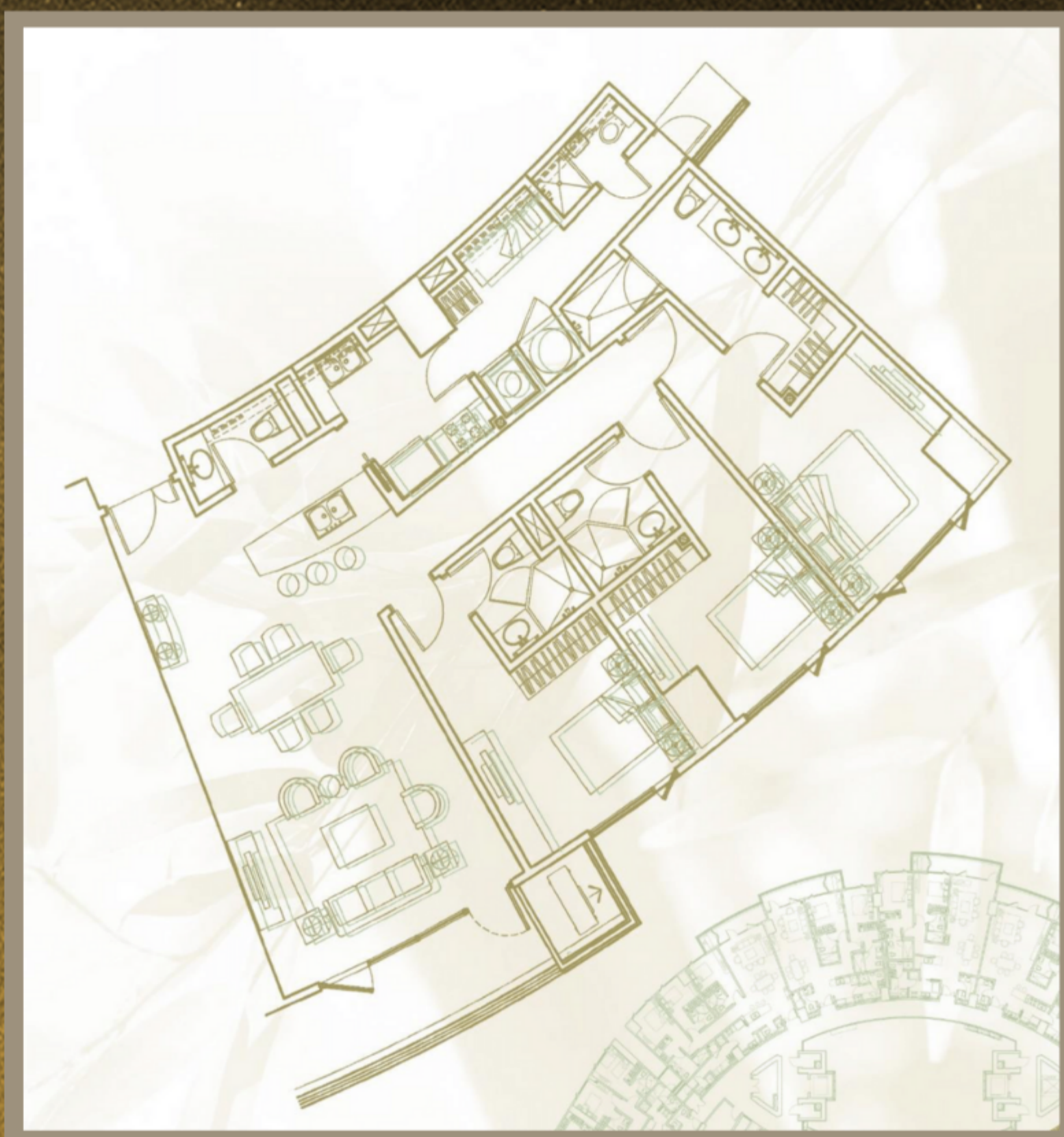

Total Area: \pm 163 sqm

Livable Area: \pm 152 sqm

- Generous living and dining area
- Kitchen with modular cabinet system
- Inclusive of basic appliances
 - Refrigerator
 - Range Oven
 - Microwave
 - Storage type Water Heater
- All bedrooms with ensuite T&B
- Powder room
- Maid's/utility area with T&B
- Greeneries view
- 3 appurtenant parking slots

A Fine Residential Masterpiece by

FILIGREE



TOWER 1

Unit 8G

TOWER 1 | 23BR DELUXE | ±163 sqm
3 Parking Slots

PARTICULARS	MAXIMUM DISCOUNT	SIZEABLE DISCOUNT, STRETCHED PERIOD			PROMO TERM
	Cash 30 days	Deferred 30% / 70% (over 24 mos)	Deferred 20% / 80% (over 24 mos)	Deferred 10% / 90% (over 24 mos)	10% / 10% (over 24 mos) / 80% thru bankfin or lumpsum
STANDARD DISCOUNT	15% (9,084,000)	5% (P3,028,000)	4% (P2,422,400)	3% (P1,818,800)	-
TOTAL CONTRACT PRICE	P66,788,400	P73,828,500	P74,532,500	P72,236,500	P77,348,500
RESERVATION FEE	P200,000	P200,000	P200,000	P200,000	P200,000
DOWNPAYMENT	P66,588,400 30 days from RF	P21,948,550 30% net of RF	P14,706,500 20% net of RF	P7,323,650 10% net of RF	P7,534,850 10% net of RF
BALANCE	-	P2,153,331.25/mo 70% over 24 mos	P2,484,416.67 80% over 24 mos	P2,821,368.75 90% over 24 mos	P322,285.42 10% over 24 mos
LUMPSUM		-	-		P61,878,800 80% lumpsum

- Reservation Fee is ₱200,000.
- Computation and schemes as of January 2024
- This document does not constitute nor form part of any contract and is for information purposes only.
- FAI reserves the right to incorporate changes and improvements without the need for notice and republication.
- Client is advised to request for detailed payment schedule for his preferred scheme from his trusted account specialist/broker.

A Fine Residential Masterpiece by

